



**TOWN OF RUTLAND, VERMONT
HIGHWAY DEPARTMENT
181 Business Route 4
Center Rutland, VT 05736
(802) 773-8128**



Driveway Installation Permit Request

Application Fee \$35 + recording fees

Driveway Permit #

Instructions:

- A) Applicant complete Part 1 and submit for review along with permit application fee.
- B) If project is approved, driveway to be installed meeting any/all conditions and standards.
- C) Once project is completed a site inspection (Part 2) must be completed PRIOR to any use.

PART 1 Driveway Installation Construction Application

Applicant (landowner) name _____

Address _____

Phone _____ E-mail _____

From Town Property Maps Page – Block – Parcel Number for Driveway _____

Installation if other than owner _____

Agent for Owner Name _____

Address _____

Phone _____ E-mail _____

Owner/Agent Signature

Provide a hand drawn sketch of the proposed driveway installation. Sketch to include a scale, proposed driveway width, diameter of any drainage lines, when required a metal or plastic Culvert with a minimum diameter of 15" inches (or sized as specified by the Road Commissioner) to be installed under the driveway.

The applicant agrees to construct access in accordance with the Town of Rutland Street and Sidewalks Ordinance adopted by the Select Board on July 7, 1980 and to notify the Town Road Commissioner once the driveway installation is complete and prior to any use. The permit holder shall be responsible for all repairs or maintenance costs of the driveway, culvert or other structure within the Town Highway Right of Way. No parking area installations are allowed within the Town Highway Right of Way.

The above applicant, being the owner () or owner's agent () of the parcel subject to this permit application is hereby granted permission to construct the driveway installation as depicted on the attached plans.

Dated _____ Authorized By: _____

Conditions to be met _____

B-71 Standard(s) To Be Met (From last page)

A B C D E F G H I

PART II Driveway Installation Use Permit Site Inspection

Inspection Date _____

Approved By _____

Acceptable YES () NO ()

If No, Why _____

ACCESS PERMIT

NOTICE: This permit is issued in accordance with Title 19 of The Vermont State Statute relative to all highways within the control and jurisdiction of the Town of Rutland. The issuance of the permit **DOES** **NOT** release the applicant from any requirements of statutes, ordinances, rules and regulations administered by other government agencies. The permit will be effective upon compliance with such of these requirements as are applicable and continue in effect for as long as the present land use continues. Any change from the present land use will require a new permit. The permit is issued subject to the directions, restrictions and conditions contained herein and on this form and any attachments hereto, and covers only the work described in this application, and then only when the work is performed as directed. Violations are subject to the penalties set forth in Title 19 of fines of not less than \$100.00 nor more than \$10,000 for each violation.

SPECIAL CONDITIONS

- 1) The permit holder shall take all necessary precautions to safeguard the traveling public until the work is completed.
- 2) Backfill shall be thoroughly compacted to prevent future settlement of highway.
- 3) Gravel, base and surface courses shall be replaced, if disturbed, by the permit holder.
- 4) All new drainage pipes within highway right of way shall be approved by the Select Board or Road Commissioner before back filling trenches.
- 5) An additional inspection and approval shall be necessary prior to **paving** drives.
- 6) No installations or parking will be allowed within the highway right of way.
- 7) All construction costs and costs of material to be at permit holders expense.
- 8) All applicable Town regulations and State Agency of Natural Resources regulations must be met.
- 9) A 15" (or size requested by the Select Board or Road Commissioner) minimum diameter galvanized culvert will be installed under the drive.
- 10) Drives to be constructed as per Detail A, B or C Standard for Residential & Commercial Drives as per Vermont Standard B-71, attached as last page.
- 11) The applicacant, or applicants agent shall be responsible for any damage, repair or maintenance of the facility within the highway limits.
- 12) No effluent from septic tank or drainage field will be allowed to drain onto highway right of way.
- 13) The slopes within the highway right of way shall be graded in a workman like manner, seeded and mulched.
- 14) The driveway to be constructed will enther town town right of way at an elevation not higher than that of the shoulder of the highway, and that the driveway to be constructed shall not exceed 5% grade per 20 feet from the edge of the traveled portion of the road, and the angle that the driveway enters the road shall be determined by the Select Board or Road Commissioner who in their determintion will be guided by safe and practical ingress and egress to the Town Highway.
- 15) Underground services will require a sleeve and markers to locate it and will be referenced on a map submitted with the permit or before use of the driveway.
- 16) All construction shall be completed within 1 (one) year of the approved application.

This page for drawing of project

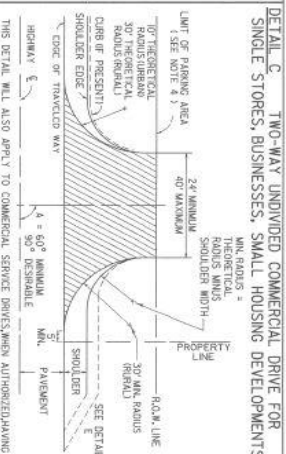
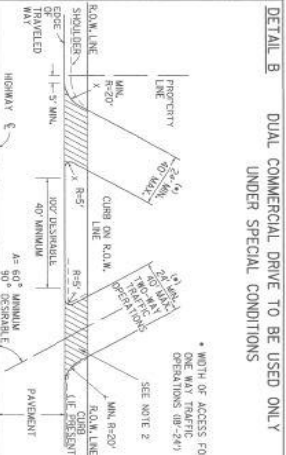
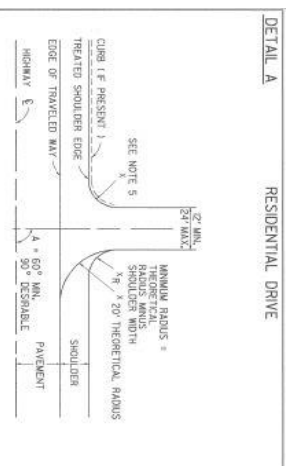

- NOTES:
- THIS SHEET IS INTENDED FOR USE BY DESIGNERS ON HIGHWAY PROJECTS AND IN CONNECTION WITH A PERMIT FOR WORK WITHIN HIGHWAY RIGHTS OF WAY. A DESIGNER SHALL BE RESPONSIBLE FOR THE DESIGN OF THE PROJECT AND SHALL BE RESPONSIBLE FOR THE DESIGN OF THE PROJECT AND SHALL BE RESPONSIBLE FOR THE DESIGN OF THE PROJECT.
 - ALL COMMERCIAL DRIVES SHALL BE PAVED FROM THE EDGE OF THE DRIVE TO THE EDGE OF THE DRIVE. THE DRIVE SHALL BE PAVED WITH A MINIMUM 12" THICKNESS OF ASPHALT OR CONCRETE. THE DRIVE SHALL BE PAVED WITH A MINIMUM 12" THICKNESS OF ASPHALT OR CONCRETE.
 - DRIVEWAY ACCESS FROM PARKING AREAS TO THE RIGHT-OF-WAY SHALL BE PROVIDED BY THE DESIGNER. THE DRIVEWAY SHALL BE PAVED WITH A MINIMUM 12" THICKNESS OF ASPHALT OR CONCRETE. THE DRIVEWAY SHALL BE PAVED WITH A MINIMUM 12" THICKNESS OF ASPHALT OR CONCRETE.
 - VEHICULAR ACCESS FROM PARKING AREAS TO THE RIGHT-OF-WAY SHALL BE PROVIDED BY THE DESIGNER. THE DRIVEWAY SHALL BE PAVED WITH A MINIMUM 12" THICKNESS OF ASPHALT OR CONCRETE. THE DRIVEWAY SHALL BE PAVED WITH A MINIMUM 12" THICKNESS OF ASPHALT OR CONCRETE.
 - DRIVEWAY ACCESS FROM PARKING AREAS TO THE RIGHT-OF-WAY SHALL BE PROVIDED BY THE DESIGNER. THE DRIVEWAY SHALL BE PAVED WITH A MINIMUM 12" THICKNESS OF ASPHALT OR CONCRETE. THE DRIVEWAY SHALL BE PAVED WITH A MINIMUM 12" THICKNESS OF ASPHALT OR CONCRETE.
 - DRIVEWAY ACCESS FROM PARKING AREAS TO THE RIGHT-OF-WAY SHALL BE PROVIDED BY THE DESIGNER. THE DRIVEWAY SHALL BE PAVED WITH A MINIMUM 12" THICKNESS OF ASPHALT OR CONCRETE. THE DRIVEWAY SHALL BE PAVED WITH A MINIMUM 12" THICKNESS OF ASPHALT OR CONCRETE.
 - DRIVEWAY ACCESS FROM PARKING AREAS TO THE RIGHT-OF-WAY SHALL BE PROVIDED BY THE DESIGNER. THE DRIVEWAY SHALL BE PAVED WITH A MINIMUM 12" THICKNESS OF ASPHALT OR CONCRETE. THE DRIVEWAY SHALL BE PAVED WITH A MINIMUM 12" THICKNESS OF ASPHALT OR CONCRETE.
 - DRIVEWAY ACCESS FROM PARKING AREAS TO THE RIGHT-OF-WAY SHALL BE PROVIDED BY THE DESIGNER. THE DRIVEWAY SHALL BE PAVED WITH A MINIMUM 12" THICKNESS OF ASPHALT OR CONCRETE. THE DRIVEWAY SHALL BE PAVED WITH A MINIMUM 12" THICKNESS OF ASPHALT OR CONCRETE.
 - DRIVEWAY ACCESS FROM PARKING AREAS TO THE RIGHT-OF-WAY SHALL BE PROVIDED BY THE DESIGNER. THE DRIVEWAY SHALL BE PAVED WITH A MINIMUM 12" THICKNESS OF ASPHALT OR CONCRETE. THE DRIVEWAY SHALL BE PAVED WITH A MINIMUM 12" THICKNESS OF ASPHALT OR CONCRETE.
 - DRIVEWAY ACCESS FROM PARKING AREAS TO THE RIGHT-OF-WAY SHALL BE PROVIDED BY THE DESIGNER. THE DRIVEWAY SHALL BE PAVED WITH A MINIMUM 12" THICKNESS OF ASPHALT OR CONCRETE. THE DRIVEWAY SHALL BE PAVED WITH A MINIMUM 12" THICKNESS OF ASPHALT OR CONCRETE.

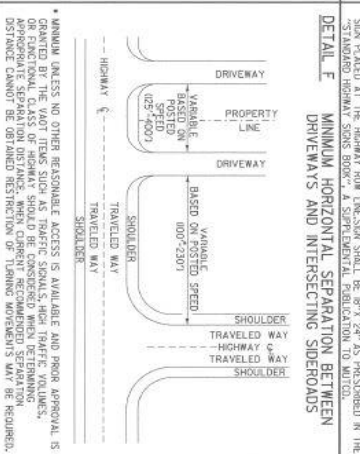
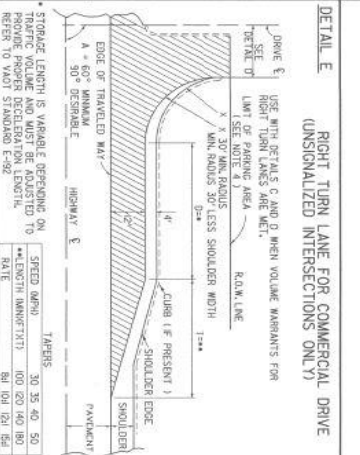
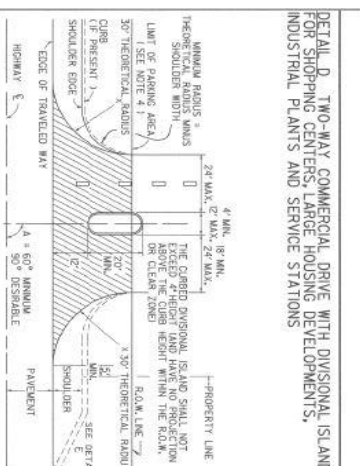

- NOTES:
- MINIMUM INSIDE DIAMETER (I.D.) OF 50' PIPE ANCHORS SHALL BE USED FOR ALL DRIVEWAYS EXCEPT THOSE LOCATED IN A HIGHWAY RIGHT-OF-WAY. THE ANCHORS SHALL BE SET IN A MINIMUM 12" THICKNESS OF ASPHALT OR CONCRETE. THE ANCHORS SHALL BE SET IN A MINIMUM 12" THICKNESS OF ASPHALT OR CONCRETE.
 - THE DRIVEWAY SHALL BE PAVED WITH A MINIMUM 12" THICKNESS OF ASPHALT OR CONCRETE. THE DRIVEWAY SHALL BE PAVED WITH A MINIMUM 12" THICKNESS OF ASPHALT OR CONCRETE.
 - DRIVEWAY ACCESS FROM PARKING AREAS TO THE RIGHT-OF-WAY SHALL BE PROVIDED BY THE DESIGNER. THE DRIVEWAY SHALL BE PAVED WITH A MINIMUM 12" THICKNESS OF ASPHALT OR CONCRETE. THE DRIVEWAY SHALL BE PAVED WITH A MINIMUM 12" THICKNESS OF ASPHALT OR CONCRETE.
 - VEHICULAR ACCESS FROM PARKING AREAS TO THE RIGHT-OF-WAY SHALL BE PROVIDED BY THE DESIGNER. THE DRIVEWAY SHALL BE PAVED WITH A MINIMUM 12" THICKNESS OF ASPHALT OR CONCRETE. THE DRIVEWAY SHALL BE PAVED WITH A MINIMUM 12" THICKNESS OF ASPHALT OR CONCRETE.
 - DRIVEWAY ACCESS FROM PARKING AREAS TO THE RIGHT-OF-WAY SHALL BE PROVIDED BY THE DESIGNER. THE DRIVEWAY SHALL BE PAVED WITH A MINIMUM 12" THICKNESS OF ASPHALT OR CONCRETE. THE DRIVEWAY SHALL BE PAVED WITH A MINIMUM 12" THICKNESS OF ASPHALT OR CONCRETE.
 - DRIVEWAY ACCESS FROM PARKING AREAS TO THE RIGHT-OF-WAY SHALL BE PROVIDED BY THE DESIGNER. THE DRIVEWAY SHALL BE PAVED WITH A MINIMUM 12" THICKNESS OF ASPHALT OR CONCRETE. THE DRIVEWAY SHALL BE PAVED WITH A MINIMUM 12" THICKNESS OF ASPHALT OR CONCRETE.
 - DRIVEWAY ACCESS FROM PARKING AREAS TO THE RIGHT-OF-WAY SHALL BE PROVIDED BY THE DESIGNER. THE DRIVEWAY SHALL BE PAVED WITH A MINIMUM 12" THICKNESS OF ASPHALT OR CONCRETE. THE DRIVEWAY SHALL BE PAVED WITH A MINIMUM 12" THICKNESS OF ASPHALT OR CONCRETE.
 - DRIVEWAY ACCESS FROM PARKING AREAS TO THE RIGHT-OF-WAY SHALL BE PROVIDED BY THE DESIGNER. THE DRIVEWAY SHALL BE PAVED WITH A MINIMUM 12" THICKNESS OF ASPHALT OR CONCRETE. THE DRIVEWAY SHALL BE PAVED WITH A MINIMUM 12" THICKNESS OF ASPHALT OR CONCRETE.
 - DRIVEWAY ACCESS FROM PARKING AREAS TO THE RIGHT-OF-WAY SHALL BE PROVIDED BY THE DESIGNER. THE DRIVEWAY SHALL BE PAVED WITH A MINIMUM 12" THICKNESS OF ASPHALT OR CONCRETE. THE DRIVEWAY SHALL BE PAVED WITH A MINIMUM 12" THICKNESS OF ASPHALT OR CONCRETE.
 - DRIVEWAY ACCESS FROM PARKING AREAS TO THE RIGHT-OF-WAY SHALL BE PROVIDED BY THE DESIGNER. THE DRIVEWAY SHALL BE PAVED WITH A MINIMUM 12" THICKNESS OF ASPHALT OR CONCRETE. THE DRIVEWAY SHALL BE PAVED WITH A MINIMUM 12" THICKNESS OF ASPHALT OR CONCRETE.

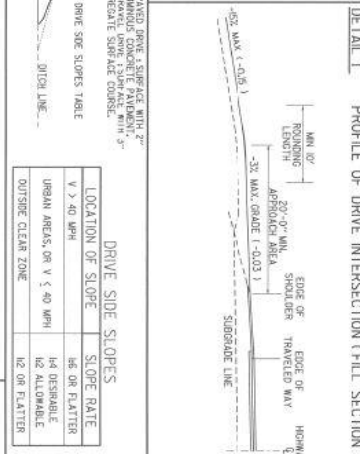
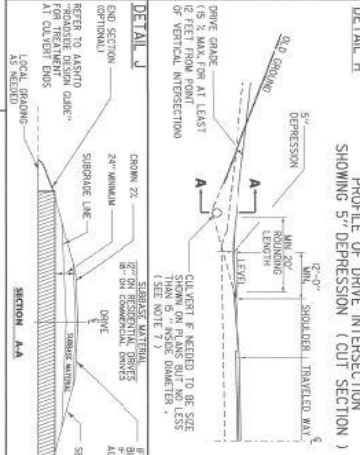
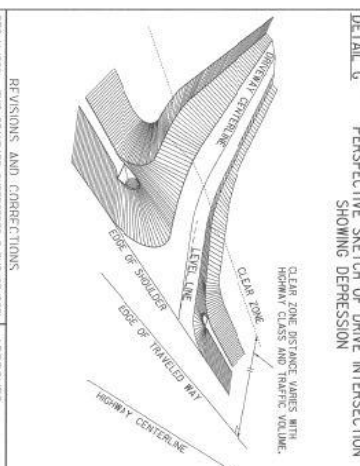

NOTE: ADVANCE WARNING SIGNS SHALL BE PROVIDED IN ACCORDANCE WITH THE VEHICLE STOPPING DISTANCE CHART. THE CHART IS BASED ON A DESIGN SPEED OF 55 MPH. THE CHART IS BASED ON A DESIGN SPEED OF 55 MPH. THE CHART IS BASED ON A DESIGN SPEED OF 55 MPH.

DESIGN SPEED (MPH)	VEHICLE STOPPING DISTANCE (FT)	VEHICLE STOPPING DISTANCE (FT)
25	55	280
30	75	380
35	100	480
40	130	580
45	165	680
50	205	780
55	250	880
60	300	980
65	355	1080

THE ABOVE VALUES ARE TAKEN FROM THE 2004 AASHTO "A" POLICY ON DETERMINING THE DESIGN OF HIGHWAYS & STREETS.

REVISIONS AND CORRECTIONS

DEC. 1, 1992 - THIS STANDARD SUPERSEDES B-717/23/600A, B-717A (12/25/90), AND B-717 (12/14/76).

JUNE 1, 1994 - REDESIGNED WITHOUT CHANGE.

MAR. 10, 1995 - REDESIGNED WITHOUT CHANGE.

NOV. 16, 2000 - CHANGES MADE TO CONFORM WITH LATEST AASHTO CRITERIA.

FEB. 1, 2004 - CHANGES MADE TO CONFORM WITH LATEST AASHTO CRITERIA.

JULY 9, 2005 - CHANGES MADE TO CONFORM WITH LATEST AASHTO CRITERIA.

APPROVED

Robert J. Leland
DIRECTOR OF HIGHWAY DEVELOPMENT

Wesley Wells
CHIEF OF OFFICES AND PERMITS

Michael J. Leland
FEDERAL HIGHWAY ADMINISTRATION

STANDARDS FOR RESIDENTIAL AND COMMERCIAL DRIVES

VERMONT DEPARTMENT OF TRANSPORTATION

STANDARD B-71